

County Hall

4TH FLOOR

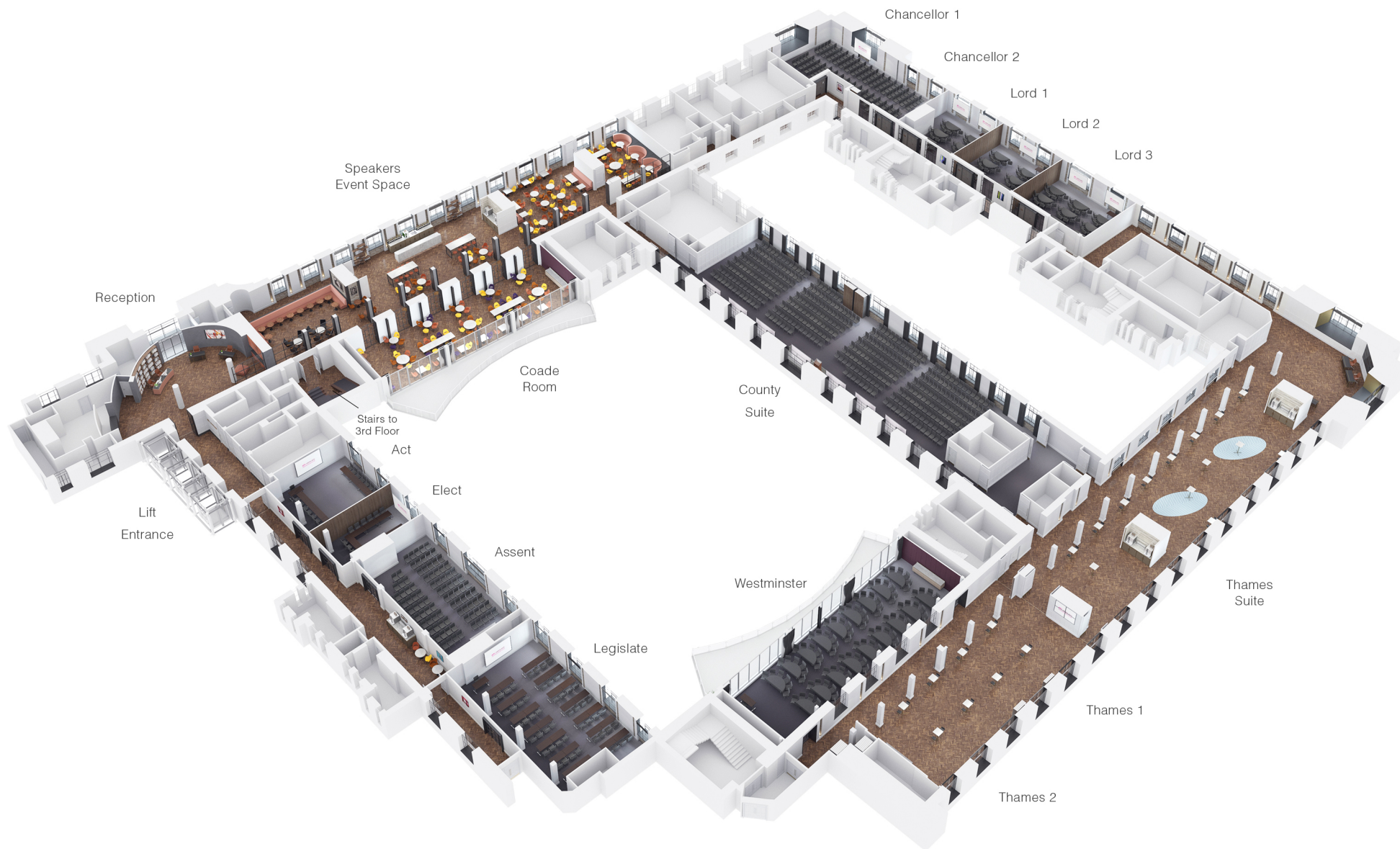

ROOMS	AREA	THEATRE	CABARET	CLASSROOM	BANQUET	BOARDROOM	U-SHAPE	EXHIBITION (stands)
Knights Lounge	220m ²	-	-	-	-	-	-	12
Baron	79m ²	80	48	40	60	32	28	-
Earl	51m ²	50	24	18	40	20	18	-
Duke Suite	139m ²	160	96	72	100	52	48	8
Duke 1	57m ²	50	24	24	40	20	16	4
Duke 2	82m ²	70	48	36	60	32	24	5
Waterloo Suite	288m ²	328	192	136	240	-	-	27
Mayor Suite	144m ²	152	108	84	120	60	56	12
Mayor 1	91m ²	96	72	56	80	40	36	-
Mayor 2	53m ²	48	30	24	40	20	16	-
Countess	70m ²	56	36	24	50	28	20	-
Baroness	34m ²	32	18	12	20	12	12	-
Duchess	76m ²	64	36	30	50	28	24	-
Dame	76m ²	64	32	30	50	28	26	-
Innovation	56m ²	60	24	24	40	24	20	-

ROOMS	AREA	THEATRE	CABARET	CLASSROOM	BANQUET	BOARDROOM	U-SHAPE	EXHIBITION (stands)
Chancellor Suite	151m ²	150	96	72	100	56	50	-
Chancellor 1	93m ²	100	60	42	60	32	24	-
Chancellor 2	58m ²	50	36	24	40	24	20	-
Lord Suite	193m ²	200	123	84	120	72	44	-
Lord 1 & 2	119m ²	120	72	60	80	44	30	-
Lord 2 & 3	137m ²	150	90	72	100	56	36	-
Lord 1	56m ²	40	36	24	30	20	18	-
Lord 2	63m ²	60	36	24	40	24	20	-
Lord 3	74m ²	70	54	36	60	28	22	-
Thames Suite Includes Thames Lounge & Thames 1 & 2	678m ²	-	-	-	280	-	-	54
Thames Lounge	444m ²	-	-	-	160	-	-	33
Thames 1 & 2	167m ²	200	108	88	120	64	56	-
Thames 1	83m ²	84	48	40	60	32	28	-
Thames 2	84m ²	84	48	40	60	32	28	-
Westminster	143m ²	150	108	88	120	60	56	-
County Suite	384m ²	400	252	180	260	-	-	36
County 1	227m ²	224	140	96	150	-	-	20
County 2	157m ²	160	96	72	120	-	-	13
The Coade Room	143m ²	-	-	-	120	-	-	8
Act & Elect	96m ²	100	60	40	60	40	34	-
Act	61m ²	60	30	24	40	28	22	-
Elect	35m ²	30	12	12	16	16	16	-
Assent	92m ²	100	48	44	70	40	36	-
Legislate	115m ²	110	48	56	80	44	38	-